

William Saunders is the trading name of Wm Saunders Partnership LLP. Wm Saunders Partnership Limited Liability Partnership is registered in England and Wales with the Registration number OC 308033. The Registered Office is Sheppard Lockton House, Colferella Way, Newark on Trent, Notts, NG24

This drawing & any design thereon is the copyright of Wm Saunders Partnership LLP and must not be reproduced without their written consent.

Contractors must verify all dimensions, levels and co-ordinates at the site before commencing any work or making any shop drawings; no dimensions to be taken from drawing.

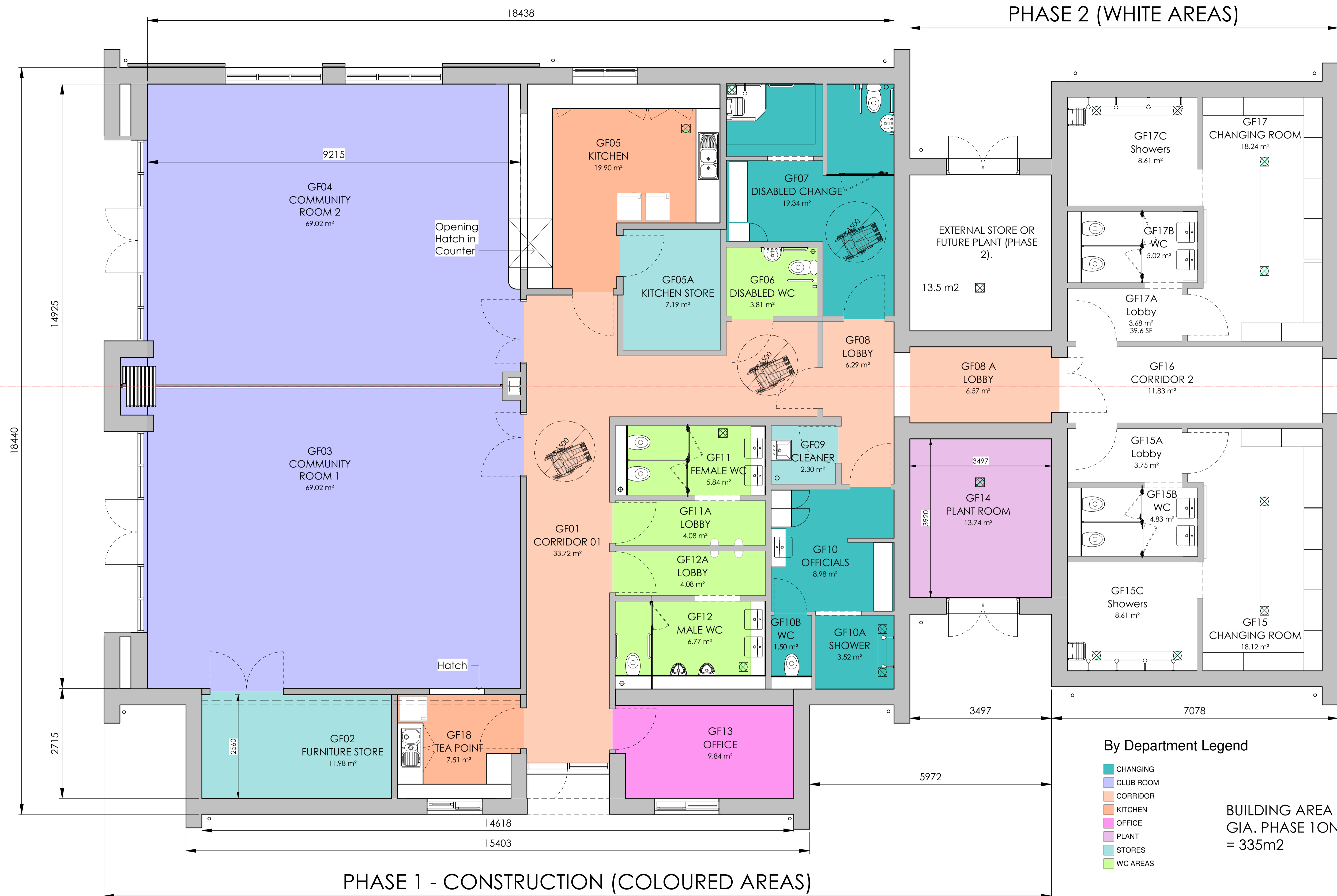

NOTE: AREAS DENOTED BY A DEPARTMENT COLOUR ON PLAN ARE IN PHASE 1 OF THE CONSTRUCTION.

AREAS INDICATED IN WHITE ARE IN PHASE 2 OF THE CONSTRUCTION.

Rev	Description	Drn	Vfd	Date
P4	Sun Pipes added. Materials annotated and issued for Planning	KAW	PF	19.05.20
P3	South West elevation, windows to community room moved closer together, as discussed at meeting 23.03.20.	KAW	PF	24.03.20
P2	Plan revised to incorporate tea point and hatch to N/W elevation and to serve the play area. Kitchen servery extended.	KAW	PF	18.03.20
P1	TO BE TABLED FOR DISCUSSION AT MEETING 9TH MARCH 2020	KAW	PF	05.03.20

As outlined in section 2.3 of the CIB8 Industry Guidance to Designers, insignificant risks can usually be ignored, as can risks arising from routine construction activities, unless the design compounds or significantly alters these risks. In accordance with CDM Regulations 8, 9 and 11, any significant risks relating to the design features shown on this drawing have been identified and are annotated thus:

No significant risks have been identified.

Significant risks have been identified - refer to notes on drawing for information on residual risks and any control measures to be employed.

Refer to the current Designer's Risk Assessment sheets for further details.

Designer's Signature: KAW Date: FEB '20

By Department Legend

- CHANGING
- CLUB ROOM
- CORRIDOR
- KITCHEN
- OFFICE
- PLANT
- STORES
- WC AREAS

BUILDING AREA
GIA. PHASE 1 ONLY
= 335m²

1 Level 0 - Proposed Ground Floor - GA Plan
Scale 1 : 50

Project
PROPOSED SPORTS PAVILION,
CHARLES HILL, LOSCOE, DERBYSHIRE

Client
AMBER VALLEY BOROUGH COUNCIL

Title
PROPOSED FLOOR PLAN - GA -
OPTION 3

WS Project No.	Drawn by	Date	Scale
12040	KAW	FEB 20	1 : 50

Drawing/Document Reference
Project Originator Zone Level Type Role Number Status Revision
12040 - WMS - ZZ - 00 - DR - A - 10404 - S2 - P4